



FEATURES

- Wide range of application valves for liquids and gas
- Reliable proven design with high flow
- Small poppet valve for tight shutoff
- Wide range of elastomers
- Mountable in any position

TECHNICAL SPECIFICATION

- Body material:** Brass UNI EN 12165 CW617N
- Armature tube:** Stainless Steel AISI 300 series
- Plungers:** Stainless Steel AISI 400 series
- Spring:** Stainless Steel AISI 300 series
- Media:** mineral oils, gasoline, diesel, fuel oils, water, air, inert fluids, inert gases, steam
- Ambient temperature:** See coils catalogue page for its compatibility
- Fluid temperature:** -10°C +140°C with FKM and EPDM seals  
-10°C +90°C with NBR seals  
-40°C +180°C with PTFE and RUBY seals
- Max allowable pressure (PS):** 40 bar
- Protection class:** IP65 (complete with electric plug)  
IP67 (with antiumidity kit can be rated to IP67)
- Electrical conformity:** IEC 335
- Switching time:** 20 - 40 msec (depending on pressure conditions)

AVAILABLE ON REQUEST

- Low lead brass for food grade
- Nickel plated version
- NSF approved version
- Double spring for higher operative pressure
- High pressure up to 100bar (see High Pressure section)
- Compressor flange interface (i.e. 4690K0V20 see Drawing reference 1a)
- Manual override (i.e. 21A3KV15-M)
- Explosion proof coil Ex m (see Atex section)
- Explosion proof coil Ex d (see Atex section)
- Explosion proof coil Ex nA (see Atex section)
- Latching coil (See coil section)

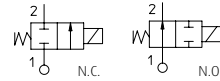

21A	1	K	V	15	21A	**	B	D	A	08	024	A	S	
Model valve	B= Flange	K= N.C.	V= FKM	10	Orefice 10 <sup>-1</sup> mm	D= for 8W coil G= for 12W-14W coil	B= 30mm Ø 13	D EN 175301-803	B= Class F	08= 8W	024= 24V	C= DC	S= Without Approval	
	1= G 1/8	Z= N.O.	B= NBR	20			U= 36mm Ø 13	V= Class H	12= 12W	112= 110V-120V	A= AC	Y= UL, CSA, VDE		
	2= G 1/4		E= EPDM	25					14= 14W	223= 220V-230V	D= AC			
	3= G 3/8		T= PTFE	30										
	4= G 1/2		R= RUBY	45										
				55										

(\*\*) Only for N.O. version

PIPE	Ø (mm)	Kv (l/min)	MAX VISCOSITY cSt (°E)	PRESSURE min	PRESSURE MAX MOPD (bar)						GAS CODE	NPT CODE	DRAWING REFERENCE
					COIL TYPE								
					AC			DC					
					B	U	G	B	U	G			

Normally Closed

Flange	1,5	1,4	12(2)	0	30	-	-	18	-	-	21A1KV15	1
	2	2	37(5)		22	35	35	16	30	30	21A1KV20	1
	2,5	3,2	53(7)		14	30	30	9	25	25	21A1KV25	1
	3	4	53(7)		10	25	25	6	18	20	21A1KV30	1
G 1/8	1,5	1,4	12(2)	0	30	-	-	18	-	-	21A3KV15	2
	2	2	37(5)		22	35	35	16	30	30	21A3KV20	2
	2,5	3,2	53(7)		14	30	30	9	25	25	21A3KV25	2
	3	4	53(7)		10	25	25	6	18	20	21A3KV30	2
G 1/4	4,5	6,5	53(7)	0	5	12	12	2	7	8	21A3KV45	2
	1,5	1,4	12(2)		30	-	-	18	-	-	21A2KV15	2
	2	2	37(5)		22	35	35	16	30	30	21A2KV20	3
	2,5	3,2	53(7)		14	30	30	9	25	25	21A2KV25	3
G 3/8	3	4	53(7)	0	10	25	25	6	18	20	21A2KV30	3
	4,5	6,5	53(7)		5	12	12	2	7	8	21A2KV45	3
	5,5	9	53(7)		3	7	10	1	2,5	5	21A2KV55	3
	4,5	6,5	53(7)		5	12	12	2	7	8	21A5KV45	4
G 1/2	5,5	9	53(7)	0	3	7	10	1	2,5	5	21A5KV55	4
	4,5	6,5	53(7)		5	12	12	2	7	8	21A8KV45	5
	5,5	9	53(7)	0	3	7	10	1	2,5	5	21A8KV55	5

Normally Open

Flange	1,5	1,4	12(2)	0	25	-	-	25	-	-	21A1ZV15D	1
	2	2	37(5)		20	-	-	20	-	-	21A1ZV20D	1
	2,5	3,2	53(7)		14	-	-	14	-	-	21A1ZV25D	1
	3	4	53(7)		10	-	-	10	-	-	21A1ZV30D	1
G 1/8	1,5	1,4	12(2)	0	25	-	-	25	-	-	21A3ZV15(*)	2
	2	2	37(5)		20	30	30	20	30	30	21A3ZV20(*)	2
	2,5	3,2	53(7)		14	17	17	14	17	17	21A3ZV25(*)	2
	3	4	53(7)		10	15	15	10	15	15	21A3ZV30(*)	2
G 1/4	4,5	6,5	53(7)	0	5	6	6	4	-	6	21A3ZV45(*)	2
	1,5	1,4	12(2)		25	-	-	25	-	-	21A2ZV15(*)	2
	2	2	37(5)		20	30	30	20	30	30	21A2ZV20(*)	3
	2,5	3,2	53(7)		14	17	17	14	17	17	21A2ZV25(*)	3
G 3/8	3	4	53(7)	0	10	15	15	10	15	15	21A2ZV30(*)	3
	4,5	6,5	53(7)		4	6	6	4	-	6	21A2ZV45(*)	3
	5,5	9	53(7)		2,5	3,5	3,5	2,5	-	3,5	21A2ZV55(*)	3
	4,5	6,5	53(7)		4	6	6	4	-	6	21A5ZV45(*)	4
G 1/2	5,5	9	53(7)	0	2,5	3,5	3,5	2,5	-	3,5	21A5ZV55(*)	4
	4,5	6,5	53(7)		4	6	6	4	-	6	21A8ZV45(*)	5
	5,5	9	53(7)	0	2,5	3,5	3,5	2,5	-	3,5	21A8ZV55(*)	5

(\*) D for B Coil; G for U/G coil

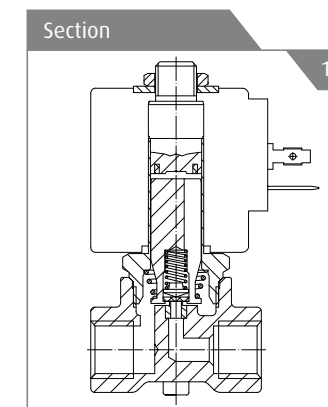

**REPAIR KIT**  
Normally Closed  
Orifice <=3mm: KT130KV30-A  
Orifice >=3mm: KT130KV55-A

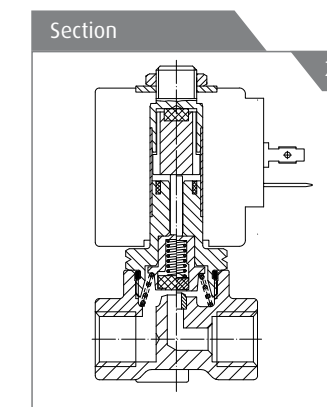

**REPAIR KIT**  
Normally Open  
Coil B type (8W)  
Orifice <=3mm: KT130ZV30-G  
Orifice >=3mm: KT130ZV55-F  
KT130KV55-A  
Coil U type (12W)  
Coil G type (14W)  
Orifice <=3mm: KT130ZV30-G  
Orifice >=3mm: KT130ZV55-G

RELATED ITEMS

- P990305: Electrical plug EN 175301-803 Pg9
- P990306: Electrical plug EN 175301-803 Pg11
- P992126: Electrical plug EN 175301-803 Pg9 (with OR screw)
- P992127: Electrical plug EN 175301-803 Pg11 (with OR screw)
- P992128: Electrical plug EN 175301-803 cable 2 wires, 53cm
- R452714: Antiumidity kit (up to IP67 protection together with plugs P992126, P992127; P992128 & H coil class)
- P992087: Timer for automatic switch

Drawing Reference

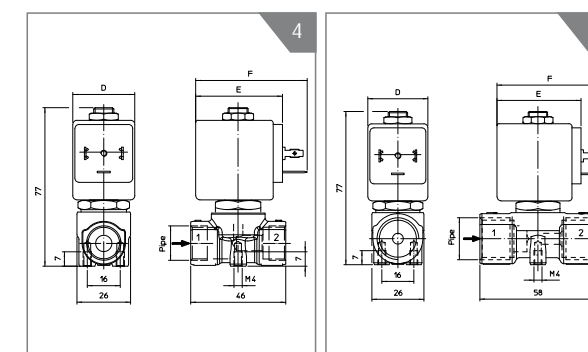
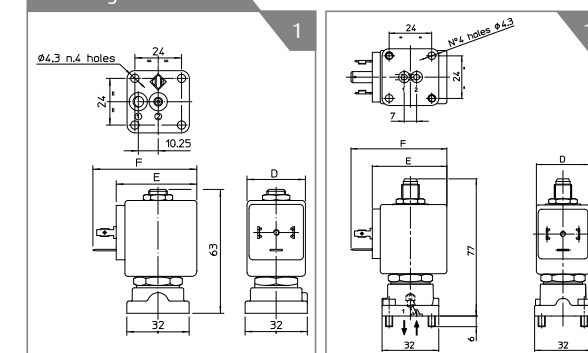

INSTALLATION

- The solenoid valves can be mounted in any position
- Other port connections available on request
- Maintenance and instruction sheet available in each solenoid valve box
- Availability of repair kit and coils as spares

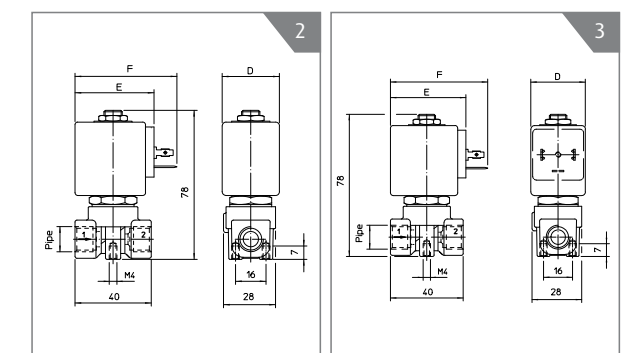

Dimensionale Table

Figure	Coil Type	D mm	E mm	F mm
1-1a-2-3-4-5	B	30	42	56
	U	36	48	60
	G	52	55	67





FEATURES

- ▶ Flow control solenoid valve
- ▶ Good repeability and low isteresys
- ▶ Different flow curves depending on the coil (contact our Customer Service)

TECHNICAL SPECIFICATION

- ▶ **Body material:** Brass UNI EN 12165 CW617N
- ▶ **Armature tube:** Stainless Steel AISI 300 series
- ▶ **Plungers:** Stainless Steel AISI 400 series
- ▶ **Spring:** Stainless Steel AISI 300 series
- ▶ **Media:** water, inert gases, mineral oils, gasoline
- ▶ **Ambient temperature:** See coils catalogue page for its compatibility
- ▶ **Fluid temperature:** -10°C +140°C with FKM seals
- ▶ **Design pressure PS:** 40 bar
- ▶ **Protection class:** IP65 (complete with electric plug)
- ▶ **Electrical conformity:** IEC 335

AVAILABLE ON REQUEST

Proportional Electric Control System suitable on request, please consult the technical department for additional information

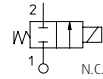

21A	2	KC	V	15		B	D	A	08	024	A	S
Model valve	2= G 1/4	K= N.C.	V= FKM	15 20 25 30 45 55	Orefice 10 <sup>1</sup> mm	B= 30mm Ø 13	D EN 175301-803	A= Class F	08= 8W	024= 24V	C= DC	S= Without Approval
						U= 36mm Ø 13		V= Class H	12= 12W	112= 110V-120V	A= AC	S= Without Approval

PIPE	Ø (mm)	Kv (l/min)	MAX VISCOSITY cSt (°E)	PRESSURE min	PRESSURE MAX MOPD (bar)						GAS CODE	NPT CODE	DRAWING REFERENCE
					COIL TYPE								
					AC			DC					
B	U	G	B	U	G								
G 1/4	1,5	1,4	21(3)	0	-	-	-	10	10	-	21A2KCV15-10		1
	2	2	21(3)		-	-	-	10	10	-	21A2KCV20-10		2
	2,5	3,2	21(3)		-	-	-	8	8	-	21A2KCV25-08		3
	3	4	21(3)		-	-	-	5	5	-	21A2KCV30-05		4
	4,5	6,4	21(3)		-	-	-	1,5	1,5	-	21A2KCV45-1X		5
	5,5	9	21(3)		-	-	-	-	1	-	21A2KCV55-01		6

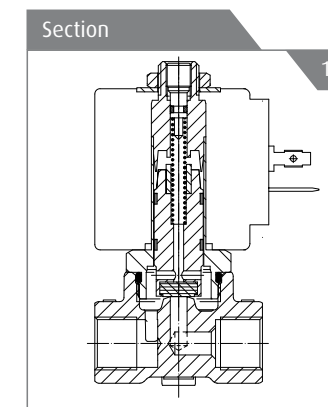

REPAIR KIT  
KT130KCV55-1

RELATED ITEMS

- ▶ P990305: Electrical plug EN 175301-803 Pg9
- ▶ P990306: Electrical plug EN 175301-803 Pg11

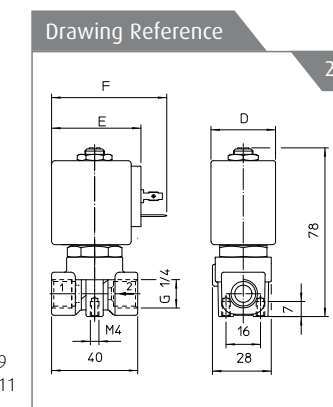

INSTALLATION

- ▶ Can be installed in any position
- ▶ Maintenance and instruction sheet available in each solenoid valve box

Flow Curve Produced with coil (8W); for 12W curve please consult technical departement

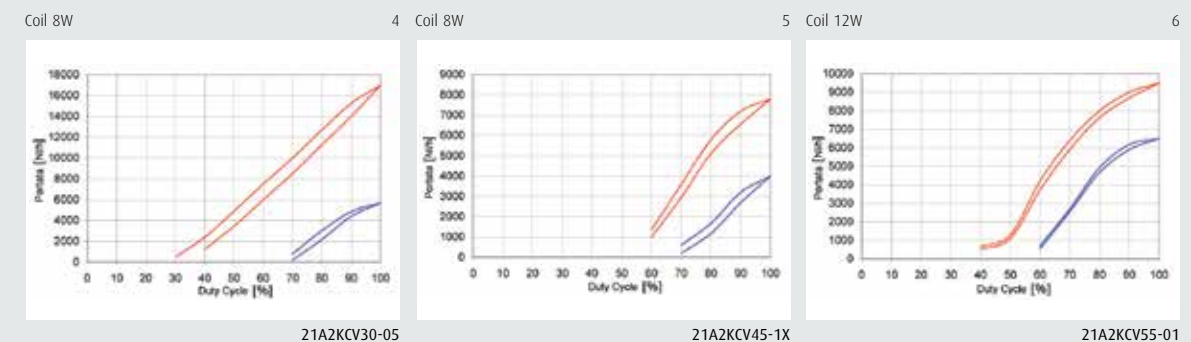
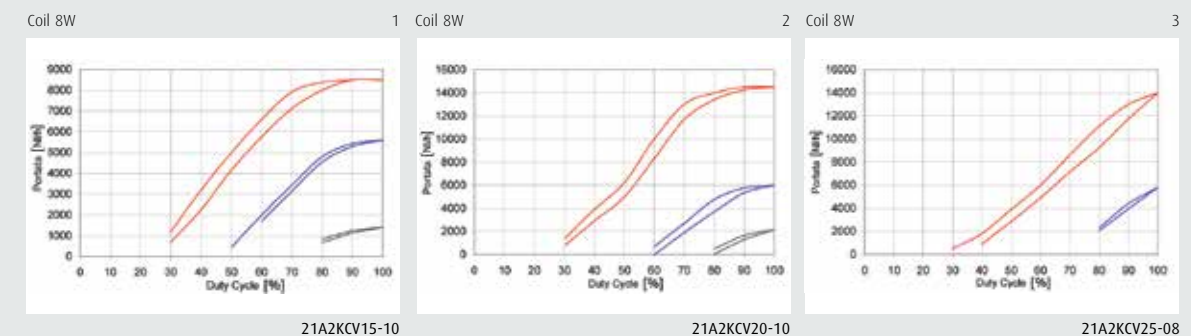

Dimensionale Table

Figure	Coil Type	D mm	E mm	F mm
2	B	30	42	54
	U	36	48	60

